

Wireless 7" Quad View Monitor With Built-in DVR

PRODUCT MANUAL

RVS-424W



 **REAR VIEW
SAFETY**

A Safe Fleet Brand

What's in the Box?



- 1 x 7" Quad View Monitor With Built-In DVR and Sunshade
- 1 x Universal Mount With Adhesive Pad
- 2 x Wireless Antennas

Table of Contents

Introduction.....	4
Safety Information	5-7
Before Beginning Installation.....	8
Installation Guide.....	9
Monitor	10
System Operation.....	11
Pairing	12
Recording.....	13
Screen Rotation	14
Image Settings	15
Playback / Audio	16
Grid Lines	17
Camera Placement System	18
Monitor Specifications	19
Camera Placement	20
Troubleshooting	21
Warranty	22
Disclaimer	23

Introduction

Congratulations on purchasing a Rear View Backup Camera System! With this manual you will be able to properly install and operate the unit.

The Backup Camera System is intended to be installed as a supplement aid to your standard rear view mirror that already exists in your vehicle. The Backup Camera System should not be used as a substitute for the standard rear view mirror or for any other mirror that exists in your vehicle.

In some jurisdictions, it is unlawful for a person to drive a motor vehicle equipped with a TV viewer or screen located forward of the back of the driver's seat or in any location that is visible, directly or indirectly, to the driver while operating the vehicle.

Safety Information

Please read the entire manual and follow the instructions and warnings carefully. Failure to do so can cause serious damage and/or injury, including loss of life. Be sure to obey all applicable local traffic and motor vehicle regulations as it pertains to this product. Improper installation will void manufacturer's warranty.

USAGE

- The Rear View Camera System is designed to help the driver safely detect people and/or objects helping to avoid damage or injury. However, you the driver, must use it properly. Use of this system is not a substitute for safe, proper or legal driving.
- Never back up while looking at the monitor alone. You should always check behind and around the vehicle when backing up, in the same way as you would if the vehicle did not have the Rear View Camera System. If you back up while looking only at the monitor, you may cause damage or injury. Always back up slowly.
- The Rear View Camera System is not intended for use during extensive back-up maneuvers or backing into cross traffic or pedestrian walkways.
- Please, always remember, the area displayed by the Rear View Camera System is limited. It does not display the entire panorama that is behind you.

Safety Information

INSTALLATION

- Electric shock or product malfunction may occur if this product is installed incorrectly.
- Use this product within the voltage range specified. Failure to do so can cause electronic shock or product malfunction.
- Take special care when cleaning the monitor.
- Make sure to firmly affix the product before use.
- If smoke or a burning smell is detected, disconnect the system immediately.
- Where the power cable may touch a metal case, cover the cable with a friction tape. A short circuit or disconnected wire may cause a fire.
- While installing the Rear View System be careful with the wire positioning in order to avoid wire damage.
- The Rear View System should only be used when the vehicle is in reverse.
- Do not watch movies or operate the monitor while driving; as it may cause an accident.
- Do not install the monitor where it may obstruct drivers view or obstruct an air bag device.
- Dropping the unit may cause possible mechanical failure.

Safety Information

If you have questions about this product, contact:

Customer Service:
Rear View Safety
1797 Atlantic Avenue
Brooklyn, NY 11233
Tel: 1.800.764.1028

IN NO EVENT SHALL SELLER OR MANUFACTURER BE
LIABLE FOR ANY DIRECT OR CONSEQUENTIAL DAMAGES OF
ANY NATURE, OR LOSSES OR EXPENSES RESULTING FROM
ANY DEFECTIVE PRODUCT OR THE USE OF ANY PRODUCT.



A Safe Fleet Brand

Before Beginning Installation

Before drilling please check that no cable or wiring is on the other side of the wall. Please clamp all wires securely to reduce the possibility of them being damaged while vehicle is in use. Keep all cables away from hot or moving parts and electrical noisy components.

Step 1: Choose the monitor and camera locations.

Step 2: Install all cables in vehicle, when necessary a 0.8 (20mm) hole should be drilled for passing camera cable through vehicles walls. Install split grommets where applicable.

Step 3: Once all cables and wiring have been properly routed and the system has paired, perform a system function test by temporarily connecting the system. If the problem persists see troubleshooting (page 20).

We recommend doing a benchmark test before installation to insure that all components are working properly.

Installation Guide

Camera Connection:

- Locate the clearance lights wiring on your vehicle. You may need to remove the interior panel in order to locate. Connect the power cables for camera: **Red** wire to light's positive; **Black** wire to chassis ground.

Monitor Connection:

- Cigarette lighter adapter: Firmly insert the lighter plug to cigarette lighter socket.
- Loose lead wire: To power the system connect the power (**RED**) 12V + wire to ignition power and the ground (**BLACK**) wire to the chassis ground. These are the only wires needed to power the system. Press power and "arrow" keys to toggle between different views.

Three positive trigger wires (**BLUE-CH2, YELLOW-CH3, WHITE-CH4**) represent a channel and activate when trigger wire connects to 12V.

- "CAM2" is the designated backup channel. To have the the backup camera display when going in reverse, connect the **BLUE** wire to reverse power (or any power source that comes on only in reverse).

The other channels can similarly be triggered (i.e. side cameras can be triggered by the turn signals, etc.)

DO NOT INSTALL monitor where it may obstruct driver view or obstruct air bag devices.

Monitor

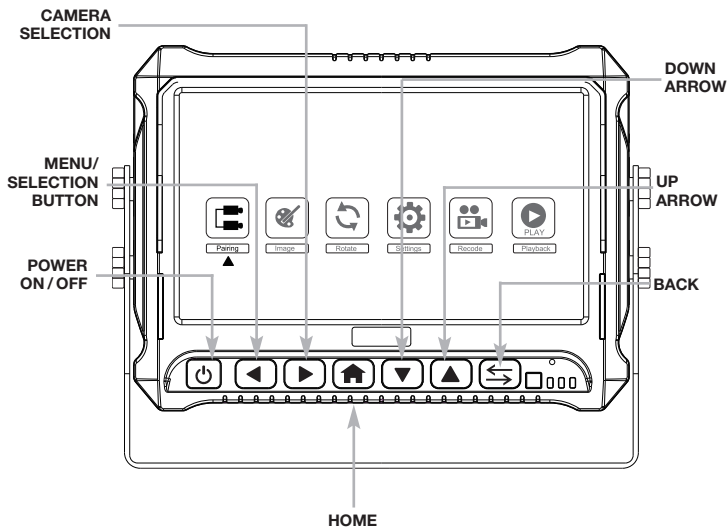

System Operation

System Operation: To turn on the monitor, press **"POWER ON"** button.

To get to Main Menu, press **"Home"** button use the up and down arrows to navigate the menu and use the **"Home"** button to confirm your selection.

To go back, press the **"REV"** (arrows) button. To adjust the volume, use the up and down arrows while viewing the camera

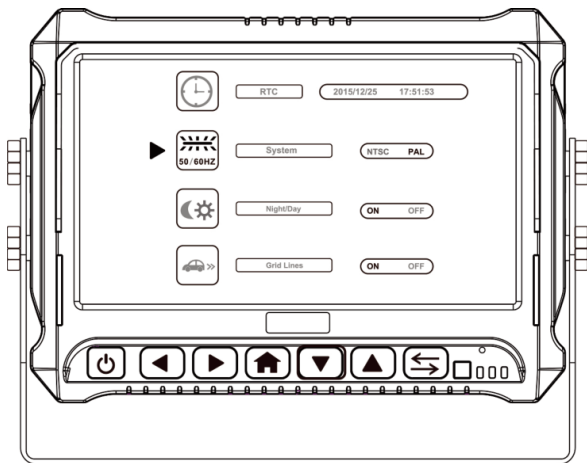

Pairing

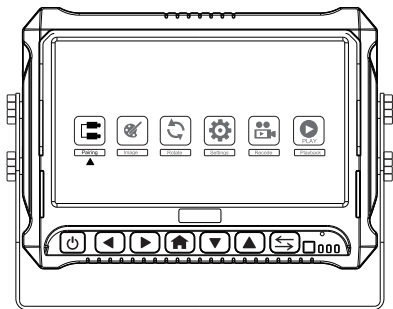

Pairing

1. Use the "right and left" arrow buttons to toggle through the channels and select the channel you want to pair to.
2. Press "Home" to open the menu and press "Home" again to initiate "pairing mode". You will see the system start counting down from 50 seconds. Once "pairing mode" is active it will last for 50 seconds.
3. Press the pair button on the back of the camera within the 50 seconds and the camera image will appear on the monitor. The system is paired. **NOTE:** Please make sure the camera is receiving power when you pair. **TIP:** If the 50 second countdown does not appear, be sure to press the menu button lightly.

Recording

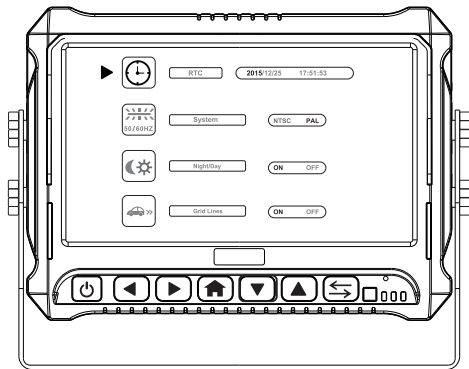

Recording: System has capabilities to record all 4 cameras. To start recording, insert a Memory card into the slot on the top of the monitor.

You will need to format the card which can be done in the "RECORD" option in the menu. After formatting, choose the channel you want to record and turn it on.

When the channel is turned on, the camera will begin recording when the system is powered on.

Overwrite option allows system to continuously record while overwriting the oldest footage.

Screen Rotation

There are advantages to rotating a screen either vertically or horizontally. Different views include :

- Standard Display** - Display in classic view
- Horizontal Reverse** - Display flipped Horizontally
- Vertical Reverse** - Display flipped Vertically
- Hand V Reverse** - Display flipped Vertically + Horizontally

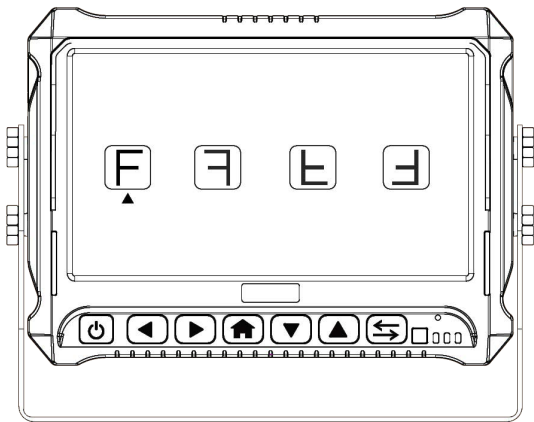
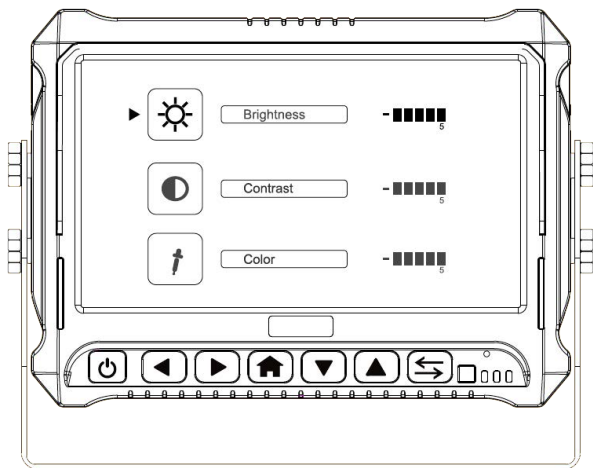

Image Settings

Image Settings: The image can be modified to the driver's specifications. Easily adjust the Brightness, Contrast, and Color to create the optimal brightness..



Playback:

For playback, select the "PLAYBACK" option in the menu and use the "HOME" button to select the file you want to play back. The "HOME" button also serves as the pause button.

Audio:

CAM2 is the audio enabled channel. When using a cigarette lighter, audio will be automatically activated. When using loose lead connections the blue wire must be receiving 12V to activate audio.

Grid Lines

Grid-lines: The grid-lines will appear on CAM2. With the cigarette lighter connection the grid-lines can be turned on/off through the menu. With the loose lead connections the grid-lines are controlled with the reverse trigger wire. When this wire is receiving 12V power the grid-lines will appear.

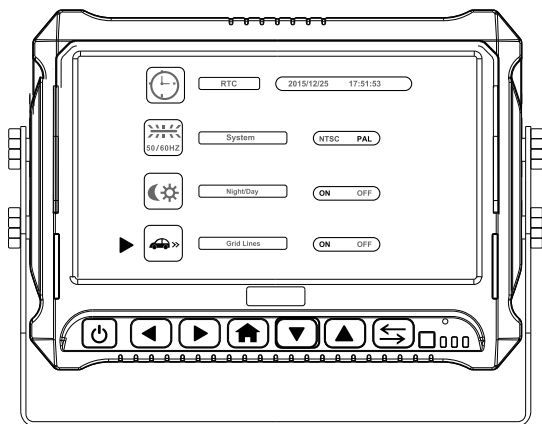

System Camera Placement

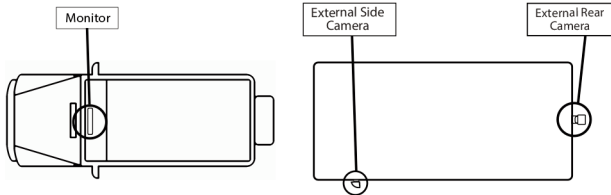
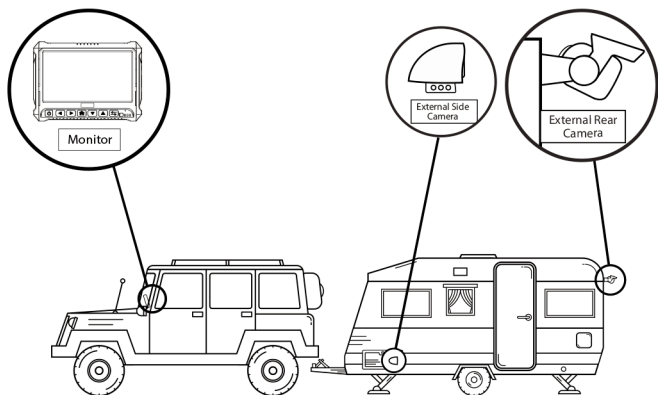

Monitor Specifications

TFT LCD Digital Monitor

Screen Size	7"
Dot Resolution	800H x 3 (RGB) 480v
Display Format	16:9 / 500:1
Display Brightness	400cd/m ²
Viewing Angle	U:50° / D:60° / R:70°
Video Input	4 channel
Video Source	1Vp-p, 75Ω
Power Supply	DC 12V(+/- 10%)
Power Consumption	5W
Operating Temperature	-30°C ~ +80° C
Video System	Auto NTSC/PAL
Overall Dimensions	7"L x 5"H x 1"D
Weight	400G
Impact Rating	5G
Dot Pitch	0.192H x 0.1805v
Sync System	Internal
Weight	520g

Camera Positioning

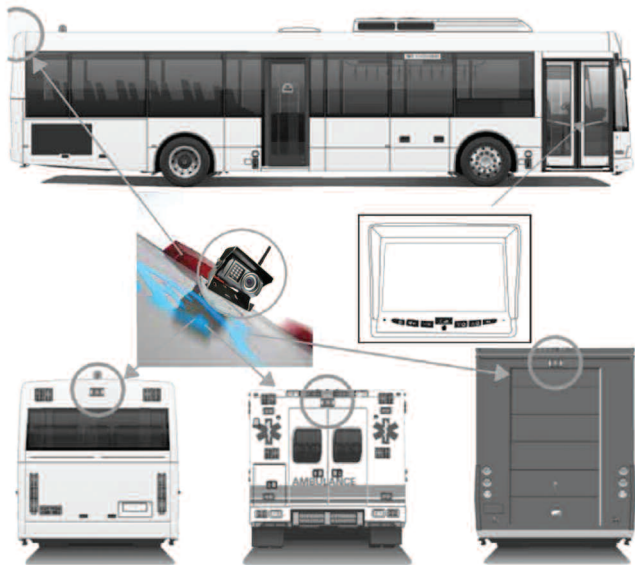

Troubleshooting

Monitor Displays Blue Screen & Displays No Signal

- Do a hard reset, unplug all cables and power cables leave out for 1 minute and then re-connect them.
- Check to ensure that the connection to the camera is tight.

No Image On Screen

- Verify camera is on correct camera input
- Verify camera is connected to power/ground

Signal Issues

- The antenna booster is an extendable antenna that can be used in case of signal issues.
- The cable is attached just like the standard antenna by screwing on the connection- The antenna itself is attached magnetically.

One Year Warranty

Rear View Safety, Inc. warrants this product against material defects for a period of one year from date of purchase. We reserve the right to repair or replace any such defective unit at our sole discretion.

Rear View Safety, Inc. is not responsible for a defect in the system as a result of misuse, improper installation, damage or mishandling of the electronic components. Rear View Safety, Inc. is not responsible for consequential damages of any kind.

This warranty is void if: defects in materials or workmanship or damages result from repairs or alterations which have been made or attempted by others or the unauthorized use of nonconforming parts; the damage is due to normal wear and tear, this damage is due to abuse, improper maintenance, neglect or accident; or the damage is due to use of the Rear View Safety, Inc. system after partial failure or use with improper accessories.

Warranty Performance

DURING THE ABOVE WARRANTY PERIOD, SHOULD YOUR Rear View Safety PRODUCT EXHIBIT A DEFECT IN MATERIAL OR WORKMANSHIP, SUCH DEFECT WILL BE REPAIRED WHEN THE COMPLETE Rear View Safety, INC. PRODUCT IS RETURNED, POSTAGE PREPAID AND INSURED, TO Rear View Safety, INC. OTHER THAN THE POSTAGE AND INSURANCE REQUIREMENT, NO CHARGE WILL BE MADE FOR REPAIRS COVERED BY THIS WARRANTY.

Warranty Disclaimers

NO WARRANTY, ORAL OR WRITTEN, EXPRESSED OR IMPLIED, OTHER THE ABOVE WARRANTY IS MADE WITH REGARD TO THIS Rear View Safety, INC. Rear View Safety, INC. DISCLAIMS ANY IMPLIED WARRANTY OR MERCHANTABILITY OR FITNESS FOR A PARTICULAR USE OR PURPOSE AND ALL OTHER WARRANTIES IN NO EVENT SHALL Rear View Safety, INC. LIABLE FOR ANY INCIDENTAL, SPECIAL, CONSEQUENTIAL, OR PUNITIVE DAMAGES OR FOR ANY COSTS, ATTORNEY FEES, EXPENSES, LOSSES OR DELAYS ALLEGED TO BE AS A CONSEQUENCE OF ANY DAMAGE TO, FAILURE OF, OR DEFECT IN ANY PRODUCT INCLUDING, BUT NOT LIMITED TO, ANY CLAIMS FOR LOSS OF PROFITS.

Disclaimer

Rear View Safety and/or its affiliates does not guarantee or promise that the user of our systems will not be in/part of an accident or otherwise not collide with an object and/or person. Our systems are not a substitute for careful and cautious driving or for the consistent adherence to all applicable traffic laws and motor vehicle safety regulations. The Rear View Safety products are not a substitute for rearview mirrors or for any other motor vehicle equipment mandated by law. Our camera systems have a limited field of vision and do not provide a comprehensive view of the rear or side area of the vehicle. Always make sure to look around your vehicle and use your mirrors to confirm rearward clearance and that your vehicle can maneuver safely. Rear View Safety and/or its affiliates shall have no responsibility or liability for damage and/or injury resulting from accidents occurring with vehicles having some of Rear View Safety products installed, and Rear View Safety and/or its affiliates, the manufacturer, distributor and seller shall not be liable for any injury, loss or damage, incidental or consequential, arising out of the use or intended use of the product. In no event shall Rear View Safety and/or its affiliates have any liability for any losses (whether direct or indirect, in contract, tort or otherwise) incurred in connection with the systems, including but not limited to damaged property, personal injury and/or loss of life. Neither shall Rear View Safety and/or its affiliates have any responsibility for any decision, action or inaction taken by any person in reliance on Rear View Safety systems, or for any delays, inaccuracies and/or errors in connection with our systems functions.



**If you have any questions
about this product, contact:**

**Rear View Safety, Inc.
1797 Atlantic Avenue
Brooklyn, NY 11233
800.764.1028**

**BETTER CAMERAS. BETTER SERVICE.
IT'S OUR GUARANTEE.**

